

LUXlink CC

INSTALLATION GUIDE

INTRODUCTION

LUXlink is designed to be seamlessly installed into fixtures with bends and curves. This guide highlights the best installation practices advised by LUXTECH and provides some useful tips and tricks to help ensure a perfect installation and save you precious assembly time.

While LUXlink is equipped with ESD protection, it is important to take the proper ESD precautions when installing LUXlink.

RECOMMENDED TOOLS



Hand Shears



ESD Strap



Cleaning Tools



Screwdriver
(Optional)

PROCEDURE

1

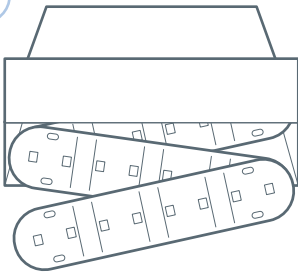

Open Package

LUXlink is designed to be opened by the smallest face so that the links can be pulled from the end to be efficiently removed and handled.

2

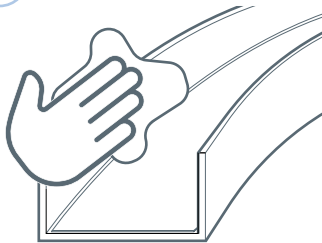

Clean Fixture

Make sure the gear tray is dry and clear of residue or debris. We recommend using a dry cloth for dust or isopropyl alcohol for grease or adhesive residue.

3

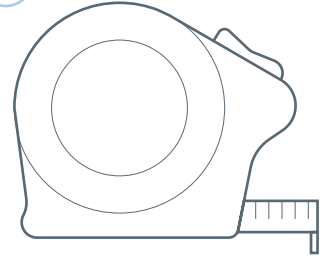

Measure Length of Fixture

Measure the length of LUXlink that will be required to fill the fixture. LUXlink is cuttable to the nearest inch to fit any fixture sizes even with variable radii.

4

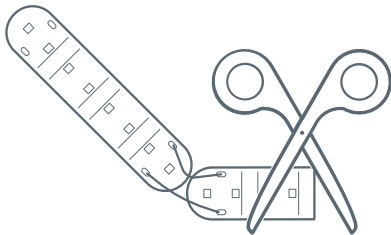

Cut LUXlink to Size

LUXlink is cuttable every inch. If a cut is required between boards, simply cut through the jumper wires. If a cut is required within a board, hand shears are recommended. Take care to cut with in the cut lines shown on the links.

5

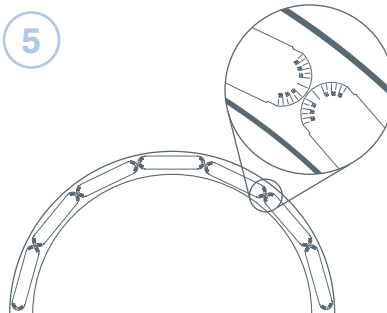

Align then Attach Sections

By butting together the ends of each link, the LED pitch between links will be perfectly maintained for optimal brightness uniformity. Use the angle markings to help with alignments of the link.

6a

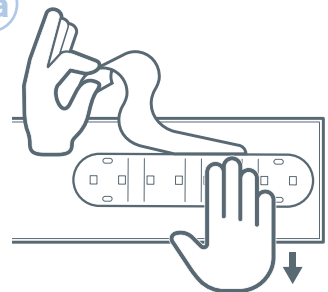

Attach Links to Fixture

LUXlink is backed with high strength adhesive and also has screw holes if screw attachment is preferred.

Pro Tip: If using the adhesive, press firmly on each section to ensure a strong bond with the adhesive. 15 PSI of adhesion pressure is recommended for optimal adhesion.

LUXlink CC

INSTALLATION GUIDE

6b

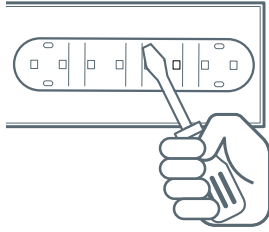

Screw Links to Fixture

If not using the high strength adhesive, use the screw holes to fasten the links onto the gear tract. The adhesive backer can be left on when using the screws.

7



Flatten Wiring

Ensure the wires are not covering LEDs after the links are attached. LUXlink uses 22-gauge core wires to connect links together which will hold their shape when bent.

Pro Tip: *Bending the wires from the middle of the wire is best practice to minimize any strain.*

8

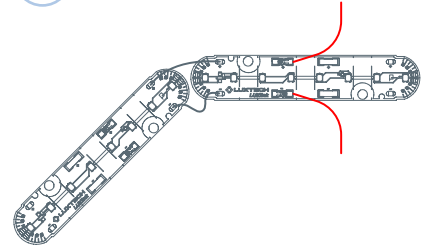

Connect to Additional Modules and Power

Each LUXlink has a set of poke in connectors that can accept 18-24AWG wire for receiving power from a driver and attaching additional links or LUXTECH modules.

CONTACT US

For assistance, please reach out at sales@luxtech.com